



4" SPEED BUMP



RubberForm's 4" was designed for use on construction sites and trucks (not recommended for pedestrian or personal vehicle use). Designed to slow traffic to 3-5 mph, they can be temporarily deployed and easily recovered whenever and wherever you need them. Their unique design not only allows them to stay in place without the use of spikes, lag bolts, and/or adhesives, but also multiple configurations and unlimited connectivity.

The 4" Speed Bump is manufactured with solid, masticated recycled rubber to withstand extreme temperatures, constant UV light, extreme weather conditions, and of course, high traffic volume. The yellow reflective stripe enables high-visibility for use in low-light or night-time conditions.

Key Features

- Easy to deploy, install, and recover
- High-visibility reflective yellow stripe for low-light conditions
- Can be used on dirt or gravel roads
- Portable or Permanent – stainless steel lag bolt and anchors for permanent installation
- Multiple configurations and unlimited connectivity
- Made in the USA with 100% masticated recycled rubber



Made in the USA



100% Recycled Material



Increase LEED Score



4" SPEED BUMP SPECIFICATIONS

Models

RF-MLSB4-YLW

- Black with safety yellow stripes

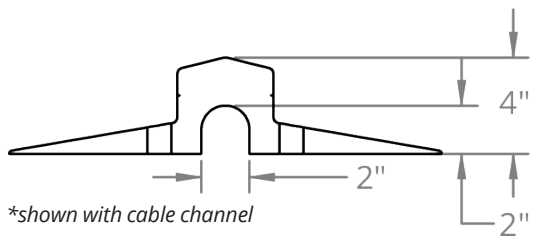
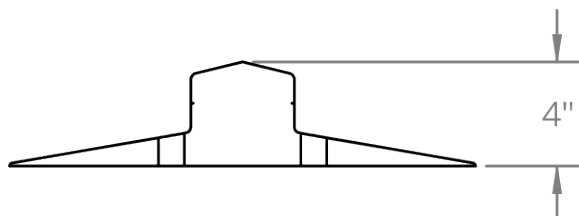
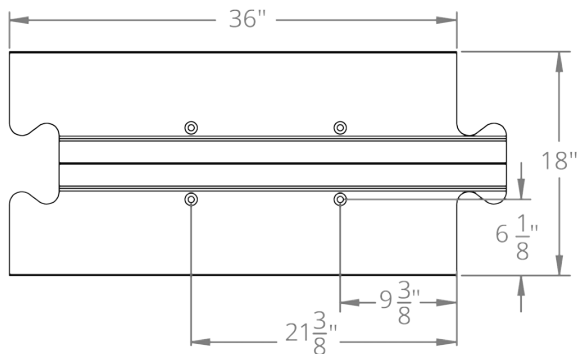

Specifications

- 40 lbs
- 4"H x 18"W x 36"L
- Masticated recycled tire rubber
- High-visibility reflective yellow stripe

**Can be fabricated with 2" x 2" cable channel by request. See drawing below.*

Hardware Kit

RF-MLSBHWK

- 4 - Lag Bolts: 3/8"W x 5"L
- 4 - Washers: 3/8"W x 1"L
- 4 - Anchors

RF-DREA14

- 14" dirt road earth anchor with drive flat top
- 1.5" tapped hole depth for threaded bolt
 - bolt, nut, and washer included
- Installs with 1-3/8" socket

