



ENGINEERED RUBBER CURB



The RubberForm Engineered Rubber Curb is a temporary or permanent curbing solution manufactured from heavy-duty recycled rubber. They offer a superior performance that easily outlasts concrete with hard-wearing durability and low maintenance.

Our rubber curbs are the ideal solution for center meridians, curb extensions, concrete curb replacement, permanent sidewalks, delineator curb systems, and lane separators. They can also be field formed down to a 5-foot radius which make them great for roundabouts, traffic circles, and islands.

RubberForm's Engineered Rubber Curb is a versatile customer-designed curbing system meant for a variety of traffic calming shapes that can be formed to your needed specifications.

Key Features

- Easy to install, remove, and relocate – for temporary or permanent use
- Flexible – conforms to road curvature and any asphalt or concrete surface
- Extremely durable – withstands heavy traffic impacts
- Resistant to temperature, UV light, oils/fuels, salts, and moisture
- Will not chip, crack, crumble, or spall
- Made in the USA with 100% American recycled rubber



Made in the USA



100% Recycled Material



Increase LEED Score



ENGINEERED RUBBER CURB SPECIFICATIONS

Models

RF-ERC36-BLK/WHT/YLW

- Rubber Curb without post hole
- Optional: Plain Black, White or Yellow stripes

RF-ERC36P-BLK/WHT/YLW

- Rubber Curb with post hole
- Optional: Plain Black, White or Yellow stripes

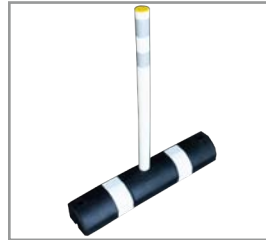
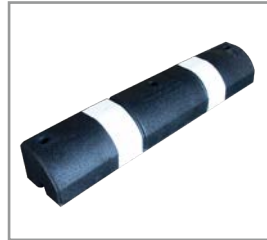
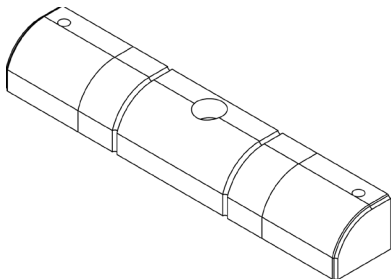

Specifications

- 32 lbs per curb
- 5"H x 6"W x 36"L
- 3 foot sections
- 3 mounting holes per curb
- Color Options: Plain Black or Plain Black with 2 White or Yellow stripes
- Available with or without post hole

Hardware Kit

RF-ERC36HWK

- 3 - 3/8" x 7" Lag Bolts
- 3 - 3/8" x 1" Washer
- 3 Anchors
- 3 Black Rubber Caps
- 1 Dual Flange Connector

