



## BUS LANE CURB

Our RubberForm Dedicated Bus Lane Transit Curbing system is an effective temporary or permanent alternative to concrete curbing. Unlike concrete, they're easy to install and just as easy to remove and relocate later. A well-engineered and dedicated bus lane protects buses, pedestrians, and other vehicles. It also can significantly increase transit time and reliability, while maintaining other traffic flow.

Our 100% American recycled composite material won't crack, crumble, or corrode. And our curbs are carefully innovated to withstand all the extremes of American roads: heat, cold, rain, ice, and snow. And of course, heavy traffic.

### KEY FEATURES:

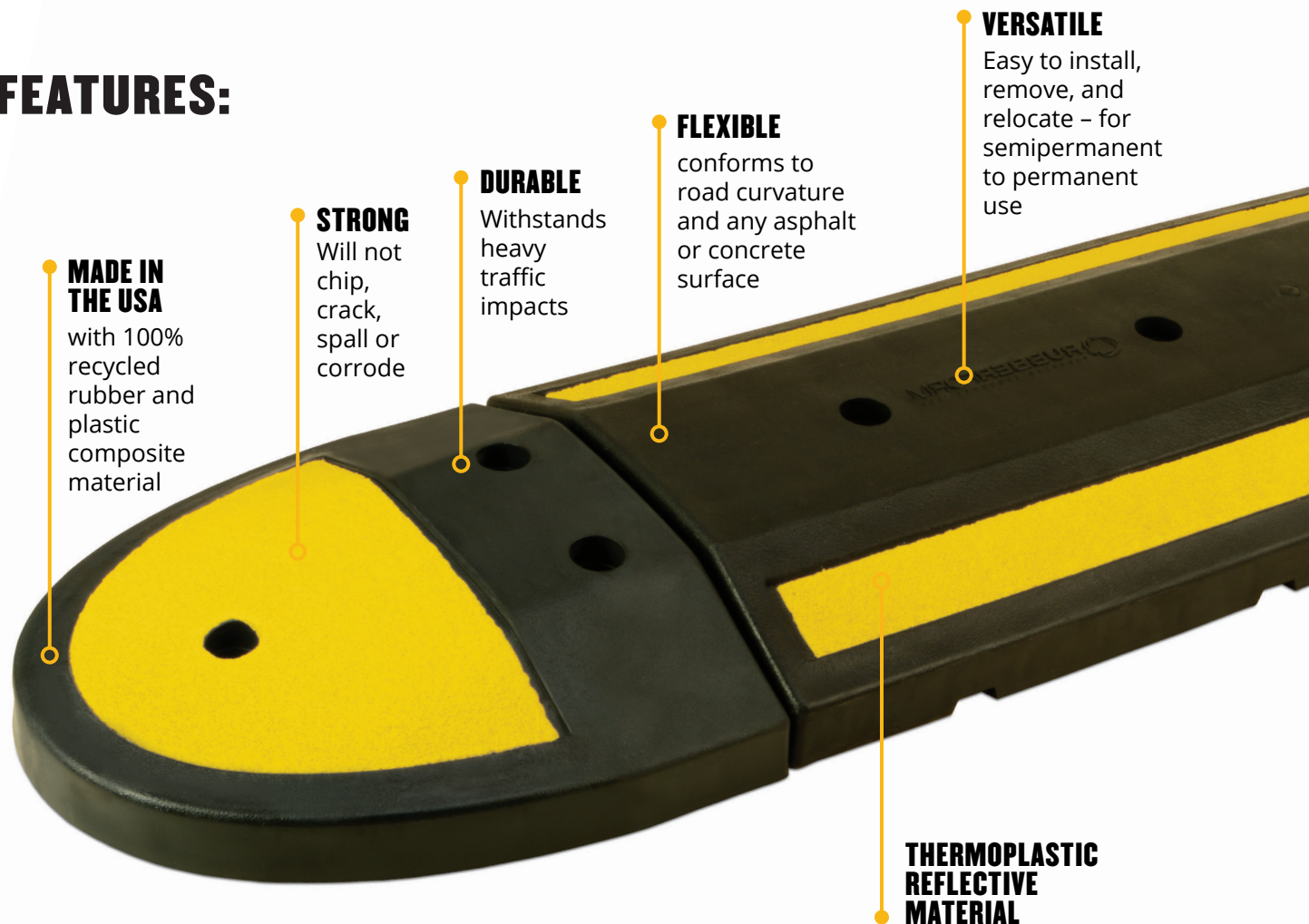

Made in the USA



100% Recycled Materials



Increase LEED Score



# BUS LANE CURB SPECIFICATIONS

## RUBBERFORM RF-BLC40YLW/WHT (CENTER MODULE)

- 3.5"H x 14"W x 40"L
- 26 lbs
- Injection Molded, recycled TPO
- 2 yellow, white or green reflective thermoplastic stripes
- 4 mounting holes



### HARDWARE KIT

#### RF-BLC40HWK

- 4-1/2"x8" LagBolts
- 4-1/2"x1-1/16" Washers
- 4-1/2"x3" Anchors
- 4 Black Rubber Caps
- 1 Dual Flange Connector

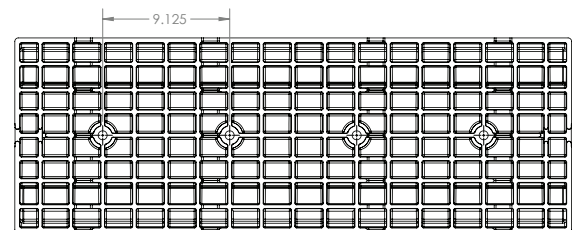
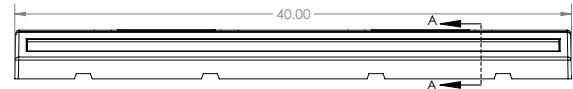
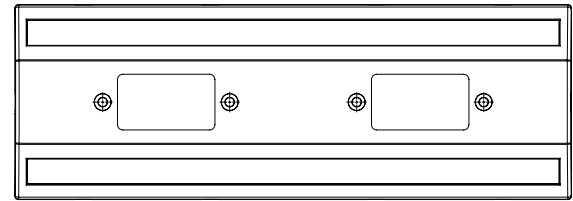

## RUBBERFORM RF-BLCECYLW/WHT (END CAP)

- 3.5"H x 14"W x 14"L
- 4 lbs
- Injection molded, recycled TPO
- 1 large yellow, white or green reflective thermoplastic stripe
- 3 mounting holes



### HARDWARE KIT

#### RF-BLCECHWK

- 3-1/2"x8" LagBolts
- 3-1/2"x1-1/16" Washers
- 3-1/2"x3" Anchors
- 3 Black Rubber Caps
- 1 Dual Flange Connector



SECTION A-A  
SCALE 1 : 6

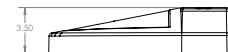
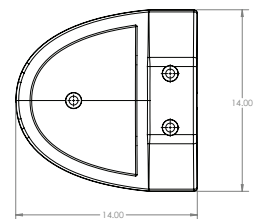
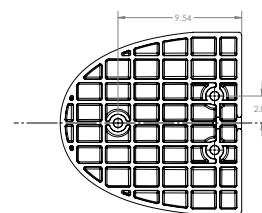
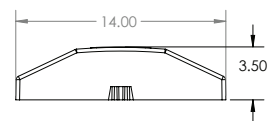

### TOOLS REQUIRED

- A 5/8" Masonry Drill Bit is needed to drill proper holes
- A 3/4 Nut Drive will be needed to secure the bolts to the lag anchor



**RUBBERFORM™**  
RECYCLED PRODUCTS, LLC

RubberForm.com | 716-478-0404

| 75 Michigan Street, Lockport, NY 14094 USA